

YE-147X DIN CABLE PLUG METAL SHIELD ASS'Y

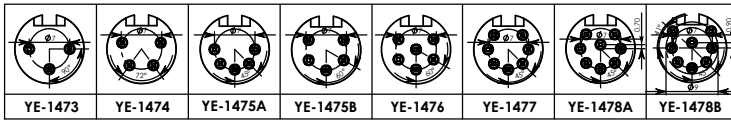
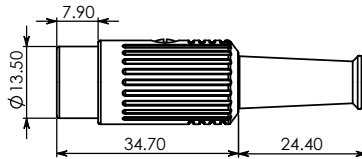
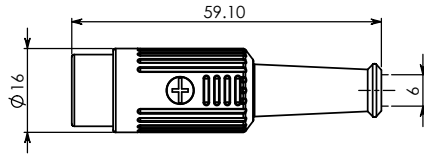

MATERIAL :

1. SHELL COVER : Zn ALLOY NICKEL PTD.
2. STRAIN BOOT : TPR
3. SET SCREW: STEEL NICKEL PTD.
4. "T" HOLDER: STEEL NICKEL PTD.
5. HOUSING : PA66
6. TERMINALS : BRASS SILVER PTD.

SPECIFICATION :

Rating : 100V AC 1A max.

Contact Resistance :

Pins 30mΩ max.

Shell 50mΩ max.

Insulation Resistance :

100MΩ at 500V DC min.

Voltage Withstand :

250V AC for 1 minute



YE-1473



YE-1474



YE-1475A



YE-1475B



YE-1476



YE-1477



YE-1478A



YE-1478B